

Windshield Wiper

Windshield Wiper Assembly and Motor

Removal

1.  **CAUTION:** The internal permanent magnets used in the windshield wiper motor (17508) are a ceramic (glass-like) material. Care must be exercised in handling the windshield wiper motor to avoid damaging the magnets. The windshield wiper motor must not be struck or tapped with a hammer or other object.

NOTE: When installing the drive arm to a new windshield wiper motor, follow the instructions included in the new windshield wiper motor kit.

Turn ignition switch to the RUN position. Turn on the multi-function switch (13K359) and cycle wipers to the mid-wipe position (straight-up) and turn the ignition key to OFF.

2. Disconnect battery ground cable (14301). Refer to [Section 14-01](#).
3. Remove LH and RH windshield wiper pivot arms (17526) as outlined.
4. Remove cowl top extension-to-hood seal.
5. Remove RH and LH cowl vent screens (018A16).

Cowl Vent Screen

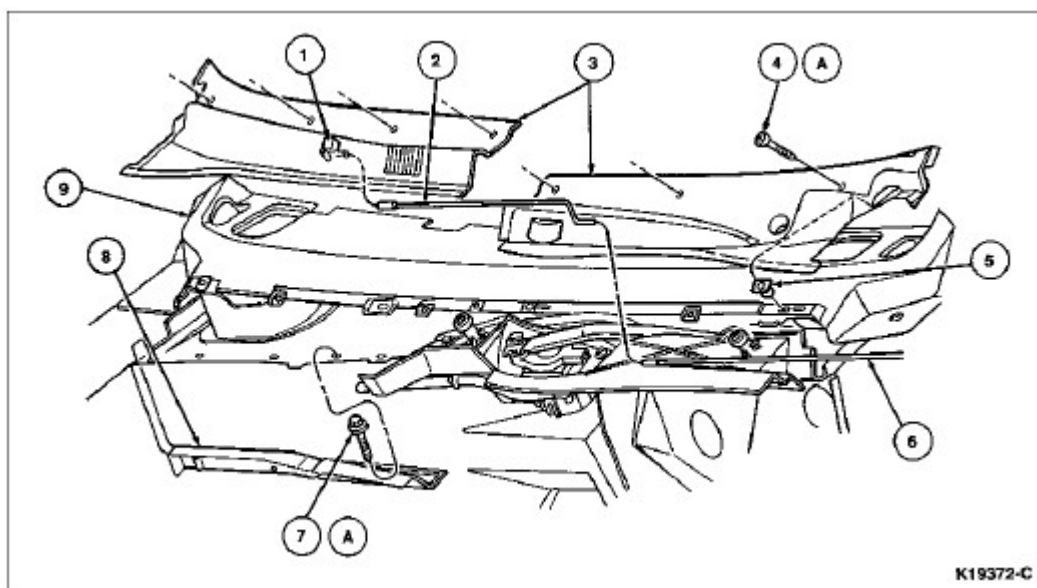

Item	Part Number	Description
1	17603	Windshield Washer Nozzle Jet and Bracket
2	17408	RH Window Washer Hose
3	018A16	Cowl Vent Screen
4	N610128-S100	Bolt (7 Req'd)
5	02316	Cowl Top Vent Grille Retainer (7 Req'd)
6	17408	LH Window Washer Hose
7	N610170-S100	Bolt and Washer (4 Req'd)
8	—	Cowl (Part of Body)
9	021A36	Cowl Top Extension
A	—	Tighten to 3-5 Nm (27-44 Lb-In)

6. Remove four retaining bolts and washers and the cowl top extension (021A36).
7. Remove six retaining bolt and washer assemblies from the windshield wiper (17500) assembly.
8. Lift the windshield wiper assembly slightly to disengage the support bracket from the dash panel mounting stud, move the windshield wiper assembly sideways about 50.8 mm (2 inches) toward the passenger side.
9. Disconnect wiring connector from the windshield wiper motor and remove the windshield wiper assembly from the vehicle.
10. Disconnect windshield wiper mounting arm and pivot shaft (17566) from the windshield wiper motor crankpin after removing the clip.

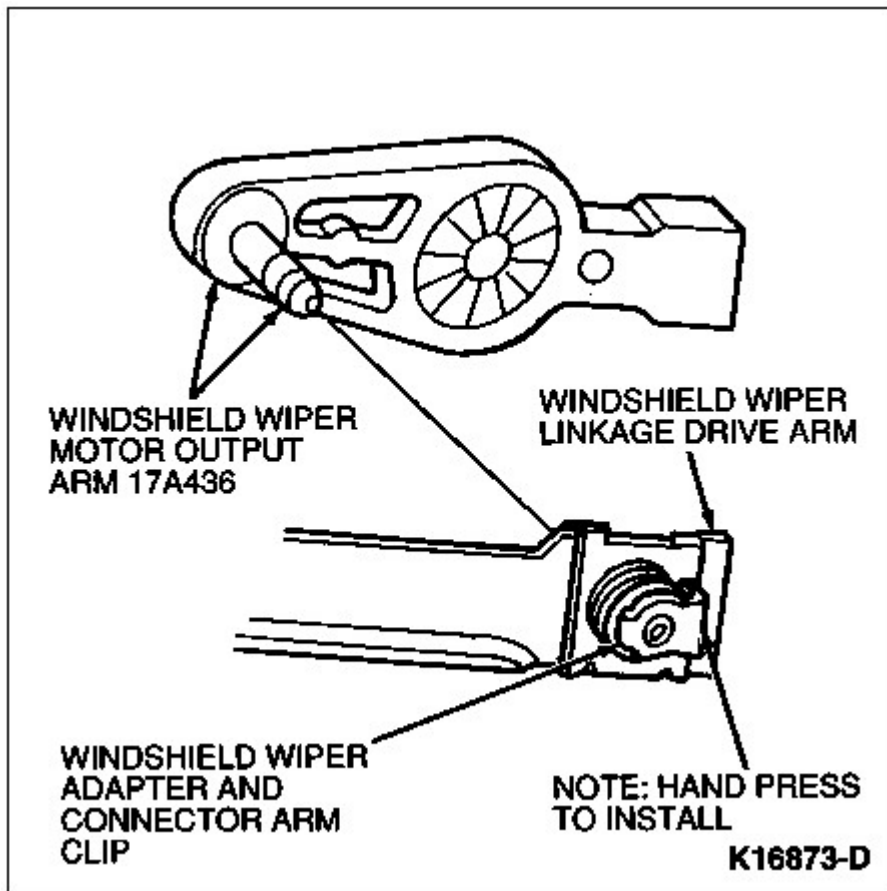

11. **NOTE:** Check location of support bracket on windshield wiper.

Remove three retaining screws and remove windshield wiper motor from the windshield wiper assembly.

Windshield Wiper Assembly and Motor

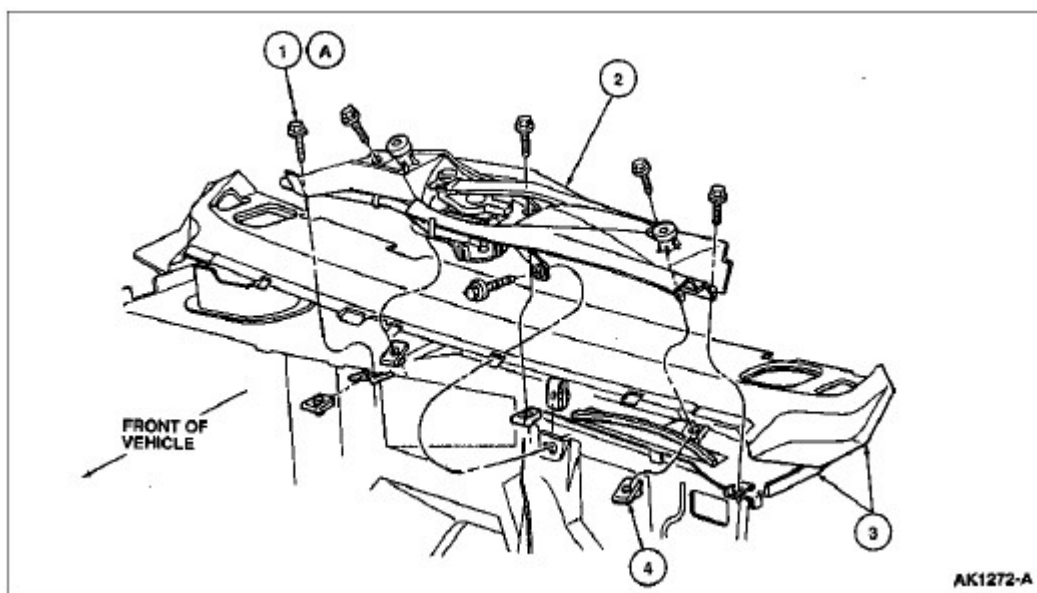

Item	Part Number	Description
1	N606678-S55	Bolt and Washer Assy (6 Req'd)
2	17500	Windshield Wiper
3	—	Cowl Top Assembly (Part of Body Assembly)
4	N623332-S100	U-Nut (6 Req'd)
A	—	Tighten to 10-14 Nm (89-124 Lb-In)

Installation

1.  **CAUTION:** Before installing the windshield wiper pivot arm and windshield wiper blade (17528) assemblies to the windshield wiper mounting arm and pivot shaft, cycle windshield wiper motor and turn off multi-function switch to ensure that the windshield wiper mounting arm and pivot shaft are in the park position.

Install windshield wiper motor. Tighten bolts to 10-14 Nm (89-124 lb-in).

2. Connect windshield wiper mounting arm and pivot shaft to windshield wiper motor crankpin and install retaining clip.
3. Position windshield wiper in cowl and connect wiring connector to windshield wiper motor.
4. Install windshield wiper assembly retaining bolts. Tighten bolts to 10-14 Nm (89-124 lb-in).
5. Install cowl top extension and retaining bolts. Tighten bolts to 3-5 Nm (27-44 lb-in).
6. Install RH cowl vent screen. Install LH cowl vent screen.
7. Connect battery ground cable. Check windshield wiper motor operation through all modes.

8. Install and adjust windshield wiper pivot arm assemblies as outlined.
9. Install windshield wiper blades as outlined.

Pivot Arm

Removal and Installation

1. **NOTE: To prevent glass and/or paint damage, do not pry windshield wiper pivot arm from windshield wiper mounting arm and pivot shaft with metal or sharp tool.**

Raise the windshield wiper blade end of the windshield wiper pivot arm off of the windshield.

2. Move the slide latch away from the windshield wiper mounting arm and pivot shaft and slowly lower the windshield wiper pivot arm onto the latch. This will unlock the windshield wiper pivot arm from the windshield wiper mounting arm and pivot shaft and hold the windshield wiper blade end of the windshield wiper pivot arm off of the windshield glass (03100) at the same time.
3. Pull windshield wiper pivot arm off of the windshield wiper mounting arm and pivot shaft without the aid of any tools.
4. To install, align the keyway on the windshield wiper mounting arm and pivot shaft with the windshield wiper pivot arm.
5. Push the windshield wiper pivot arm head over the windshield wiper mounting arm and pivot shaft. Make sure the windshield wiper mounting arm and pivot shaft in PARK position.
6. While applying downward pressure on the windshield wiper pivot arm head to ensure full seating, raise the other end of the windshield wiper pivot arm sufficiently to allow the latch to slide under windshield wiper mounting arm and pivot shaft to the latched position, using finger pressure only to slide latch.
7. Lower the windshield wiper blade to the windshield glass. If the windshield wiper blade does not touch the windshield glass, the slide latch is not completely in place.

Pivot Arm, Windshield Wiper

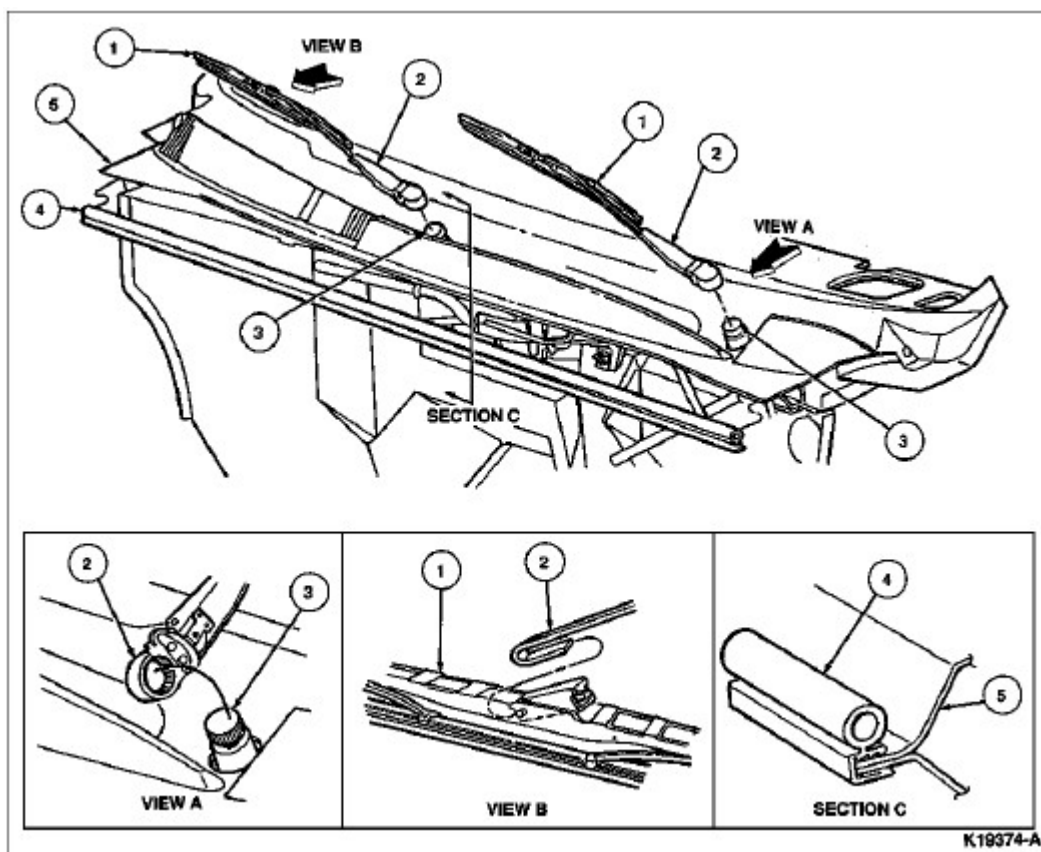

Item	Part Number	Description
1	17528	Windshield Wiper Blade
2	17526	Windshield Wiper Pivot Arm
3	17566	Windshield Wiper Mounting Arm and Pivot Shaft
4	16740	Hood Pad
5	018A16	Cowl Vent Screen

Wiper Blade

Removal and Installation

1. Press release on windshield wiper blade.
 2. Pull windshield wiper blade from windshield wiper pivot arm. Remove windshield wiper blade.
 3. To install, reverse Removal procedure.
-

